

# *Saint Paul's And Saint Francis de Sales Cemetery Information.*

Page 1.....Fees & Surcharges

Page 2.....Stone Specifications

Page 3.....Headstone Application Form

Page 4.....St. Paul's Cemetery Layout

Page 5.....St. Francis deSales Cemetery Layout

Page 6.....Local Monument Companies

---

## **Fees and Surcharges**

**Grave:** \$450 (25% to Key Bank perpetual care investment fund (\$112.50)

**Opening:** Adult or Child \$850 to excavating co.

Infant \$300 to excavating co.

**Cremated Remains:** \$150 to relevant cemetery

**Surcharges:** Funeral services office charge \$100 to parish

Cemetery services processing fee, grave site clean up, and seeding: \$130 to respective cemetery

**Labor:** For any other services requested of our cemetery staff: \$20/hr. plus cost of supplies

# STONE SPECIFICATIONS

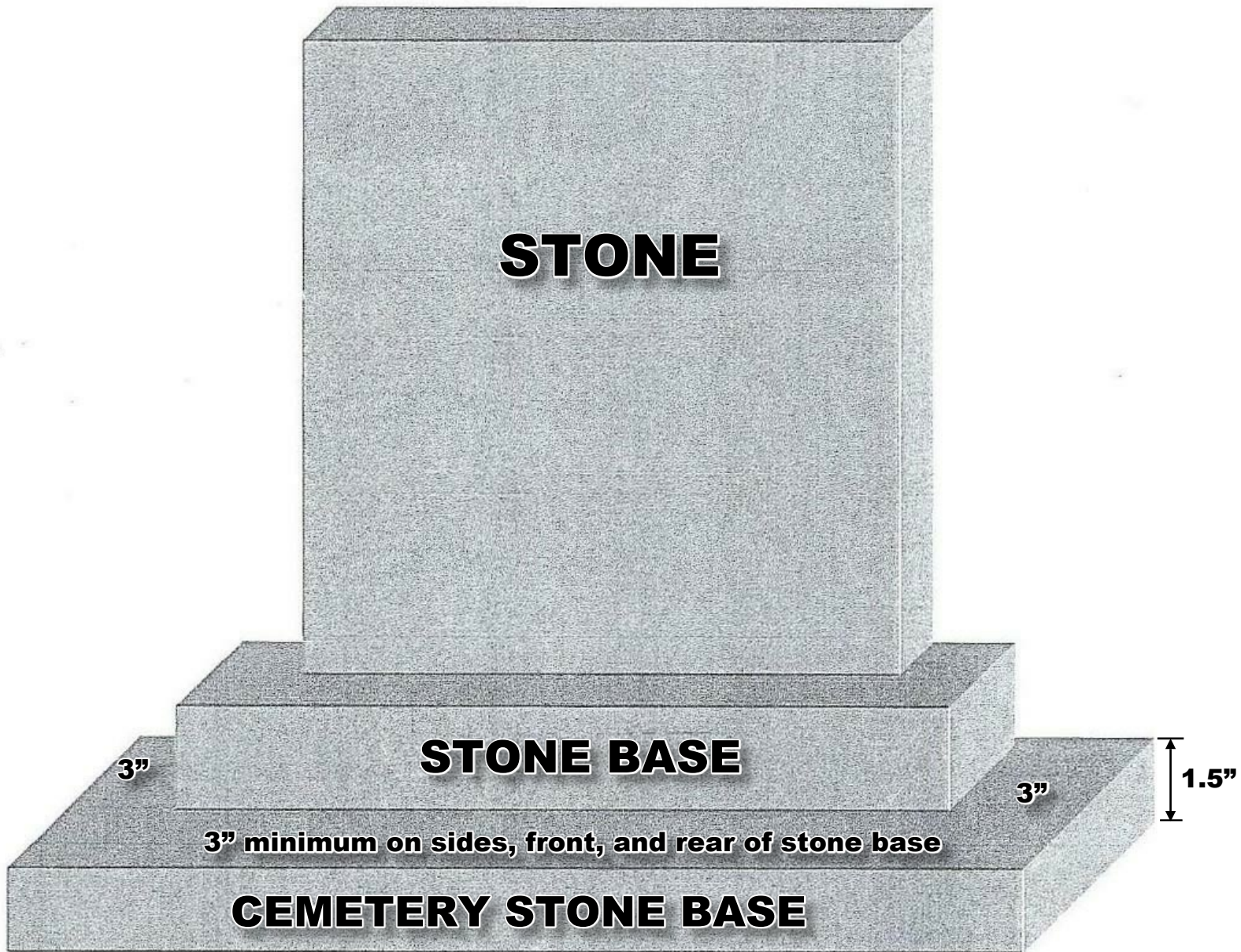

**Stone Base Minimum 1.5" Solid Slate**

MEMORIAL INSTALLATION APPLICATION

for \_\_\_\_\_ Cemetery

The Cemetery reserves the right at all times to prescribe the kind, design, size, symbolism, quality and material of all memorials or inscriptions placed in the Cemetery. All owners or anyone duly authorized to act for and in behalf of a lot owner, before ordering any memorials or inscriptions must secure from the Cemetery written approval of the design, size, material and lettering style. No memorial shall be installed without an application signed by the lot owner and approved by the Cemetery.

Please type or print.

Memorial Company \_\_\_\_\_ Contact \_\_\_\_\_ Tel # \_\_\_\_\_

Address \_\_\_\_\_

Lot Owner \_\_\_\_\_ Deceased \_\_\_\_\_

Section \_\_\_\_\_ Lot \_\_\_\_\_ Grave \_\_\_\_\_

☐ Marker overall size L \_\_\_\_\_ W \_\_\_\_\_

☐ Monument base size L \_\_\_\_\_ W \_\_\_\_\_

Color and Material \_\_\_\_\_ Installation fee \$ \_\_\_\_\_

Payment of installation charges and a sketch of the proposed memorial showing all elevations, dimensions and inscriptions must accompany this application. Completed memorials that do not conform with the approved Memorial Installation Application may be rejected by the Cemetery.

*I certify that I have the legal right to authorize this memorial installation.*

Signed \_\_\_\_\_ Date \_\_\_\_\_

Print Name \_\_\_\_\_ Relationship to Lot Owner \_\_\_\_\_

Address \_\_\_\_\_ Tel # \_\_\_\_\_

----- Cemetery Use Only -----

Date Received \_\_\_\_\_

Payment received \$ \_\_\_\_\_ Receipt # \_\_\_\_\_

Certificate of Insurance on file Yes \_\_\_\_\_ No \_\_\_\_\_

Application approved or rejected by \_\_\_\_\_ Date \_\_\_\_\_

(Please circle)

Reason for rejection \_\_\_\_\_

Completed by \_\_\_\_\_ Date \_\_\_\_\_



# St. Paul the Apostle Cemetery

Just west of Hancock, on Old Rt. 17, St. Paul's Cemetery overlooks the West Branch of the Delaware and the train tracks, and is bounded to the North, West, and South by Riverview Cemetery (municipal).

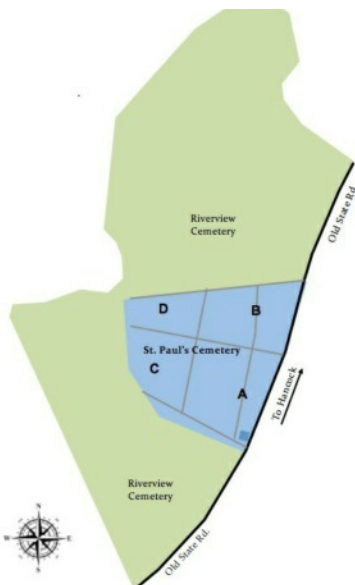
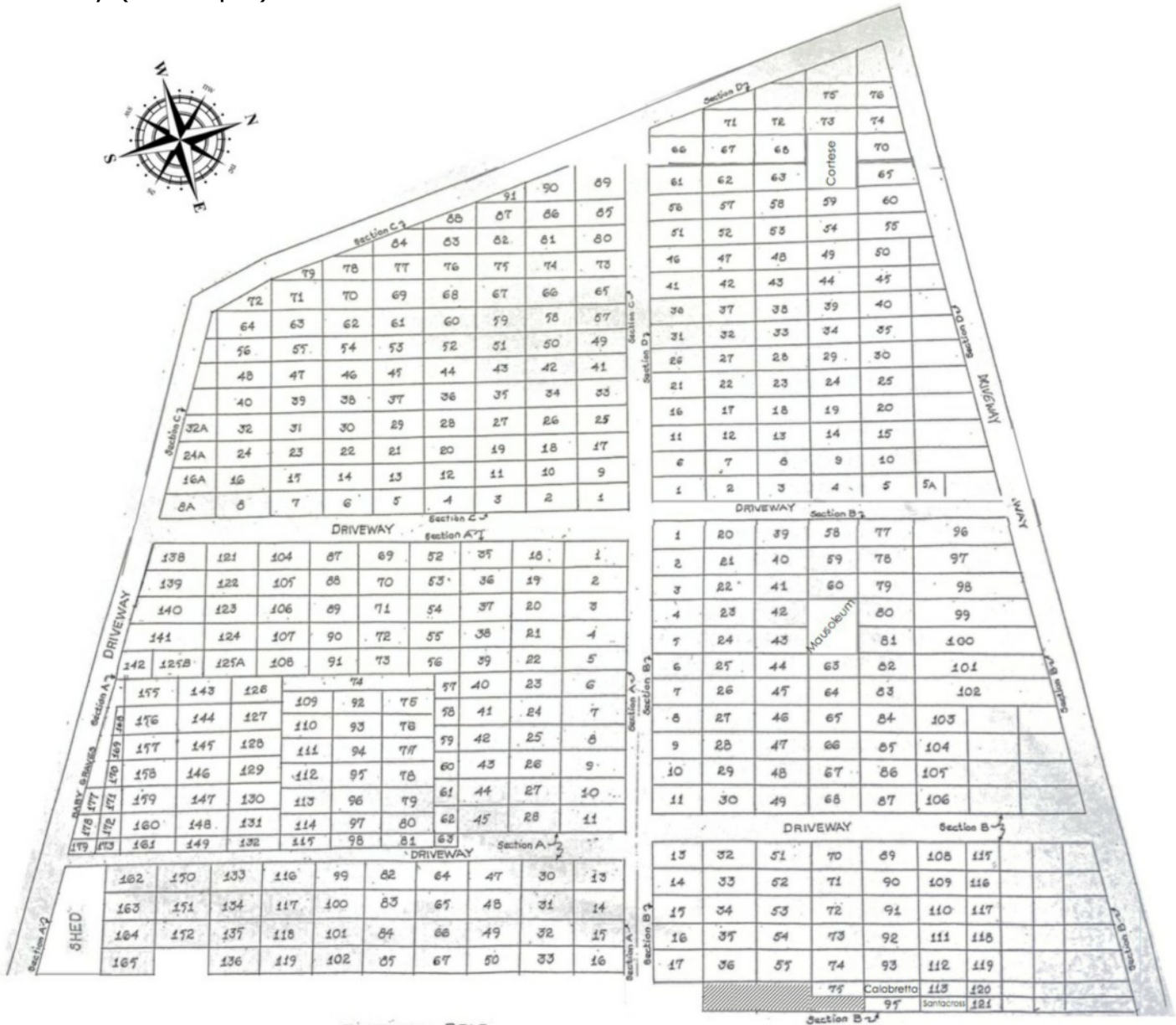

## St. Francis deSales Cemetery

In French Woods, off NY Route 97, St. Francis deSales Church is almost all that remains of the French Woods Settlement, founded by French and German immigrants to the area in the 19th century. It is located at the intersection of Riverview and Gilleran Roads, South of the

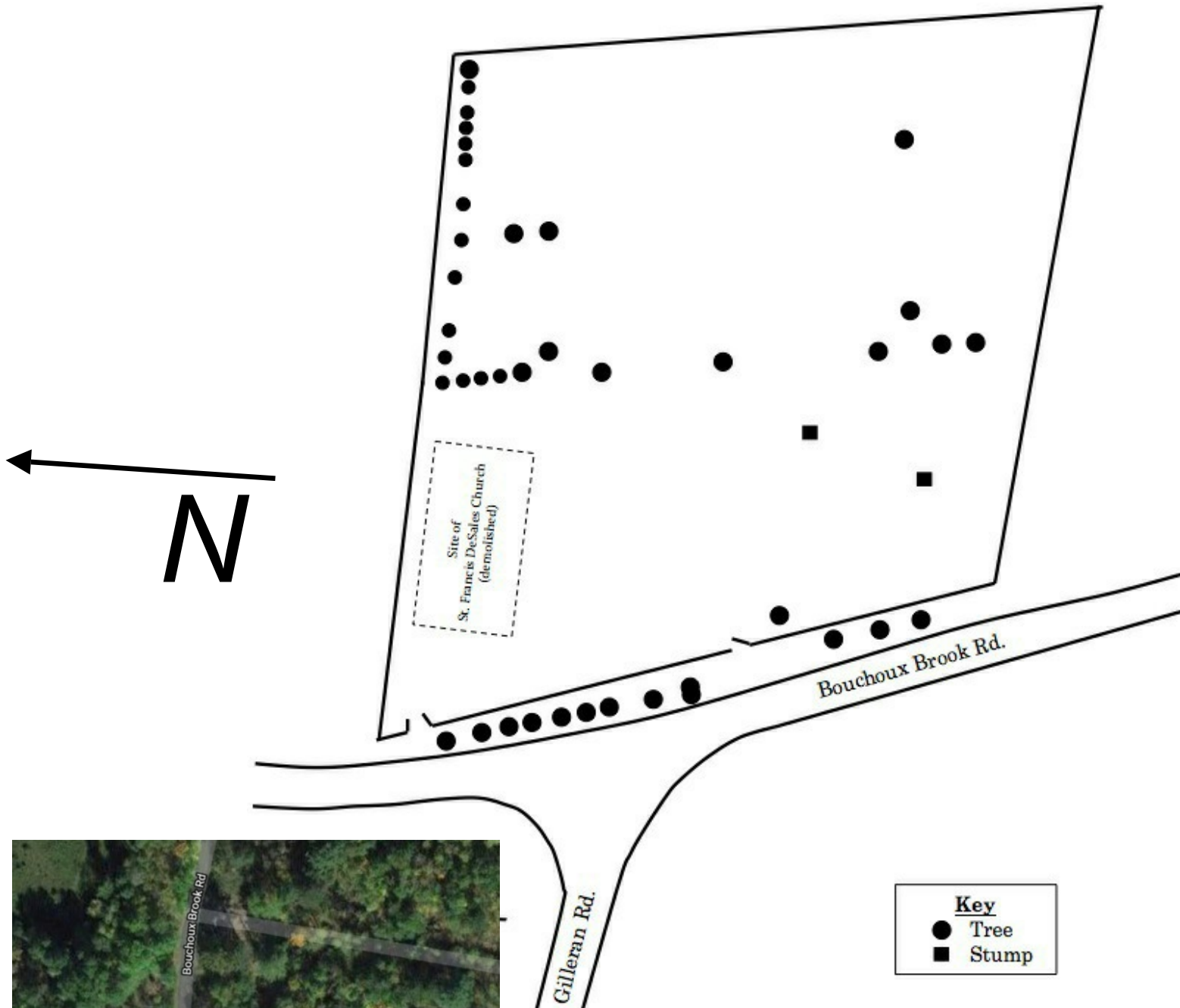

## **Cemetery Monument Companies**

### ***Martin Caufield Memorial Works***

249 Sunrise Avenue  
Honesdale, PA 18431  
Office: 1-570-253-3300  
Toll Free: 1-800-824-5293  
Fax: 1-570-253-3360  
Phillip Monaghan

### ***Monuments by Parise***

1975 Scranton Carbondale Highway  
Blakely, PA 18447  
Office: 1-570-382-3558  
Fax: 1-570-282-8701  
Jeffrey, Jonathan & Jason

### ***Cemetery Memorial Service***

74 Gosper Road (Rd 3 P.O. Box 39)  
Walton, NY 13856  
Office: 1-607-865-4694  
Fax: 1-607-865-9215  
Mike Furman

### ***Cherry Valley Memorials, Inc.***

11 Genesee St (P.O. Box 481)  
Cherry Valley, NY 13320  
Office: 1-800-838-8201  
Fax: 607-264-3101

### ***Binghamton-Johnson City Monument***

103 Burbank Avenue  
Johnson City, NY 13790  
Office: 1-607-797-2922

### ***Bainbridge Memorial Works, Inc.***

92 N Main Street  
Bainbridge, NY 13733  
1-607-967-3986

### ***Endicott Memorials***

2503 East Main Street  
Endicott, NY 13760  
Office: 1-607-785-3731